



Sanitary ferrule





Technical data

Standard	DIN, 3A, SMS, BS, ISO, GB
Size	1" - 12" DN10-DN250 17.2-168.3 304,
Material grade	304L, 316, 316L (Forging) NBR,
Seal	Silicone, EPDM, FPM, PTFE
Roughness	1. Ras1 .6µm
	2. Outsides1.6µm
	3. Ras0.4 (Polished)





Clamp Ferrule-DIN

DIN-14WMP/14MMP/14AMP

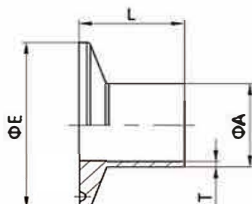

Size	A	T	E	L ¹	L ²	L ³
10	12/13	1.5	34.0	12.7	21.5	28.6
15	18/19	1.5	34.0	12.7	21.5	28.6
20	22/23	1.5	34.0	12.7	21.5	28.6
25	28/29	1.5	50.5	12.7	21.5	28.6
32	34/35	1.5	50.5	12.7	21.5	28.6
40	40/41	1.5	50.5	12.7	21.5	28.6
50	52/53	1.5	64.0	12.7	21.5	28.6
65	70	2.0	91.0	12.7	21.5	28.6
80	85	2.0	106.0	12.7	21.5	28.6
100	104	2.0	119.0	15.8	21.5	28.6
125	129	2.0	155.0	15.8	21.5	28.6
150	154	2.0	183.0	15.8	21.5	28.6

Clamp Ferrule-DIN

DIN-14MP

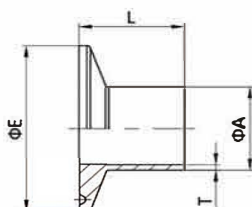

Size	A	T	E	L
10	12/13	1.5	34.0	18.0
15	18/19	1.5	34.0	18.0
20	22/23	1.5	34.0	18.0
25	28/29	1.5	50.5	21.5
32	34/35	1.5	50.5	21.5
40	40/41	1.5	50.5	21.5
50	52/53	1.5	64.0	21.5
65	70	2.0	91.0	28.0
80	85	2.0	106.0	28.0
100	104	2.0	119.0	28.0
125	129	2.0	155.0	28.0
150	154	2.0	183.0	28.0

Long Clamp Ferrule-DIN

DIN-14MPW

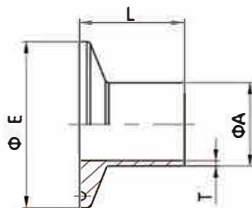

Size	A	T	E	L
10	12/13	1.5	34.0	28.6
15	18/19	1.5	34.0	28.6
20	22/23	1.5	34.0	28.6
25	28/29	1.5	50.5	36.0
32	34/35	1.5	50.5	36.0
40	40/41	1.5	50.5	36.0
50	52/53	1.5	64.0	36.0
65	70	2.0	91.0	48.0
80	85	2.0	106.0	48.0
100	104	2.0	119.0	48.0

Clamp Ferrule-INCH

3A-14WMP/14MMP/14AMP

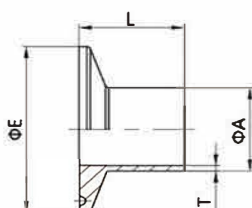

Size	A	T	E	L ¹	L ²	L ³
1/2"	12.7	1.65	25.2	12.7	21.5	28.6
3/4"	19.05	1.65	25.2	12.7	21.5	28.6
1"	25.4	1.65	50.5	12.7	21.5	28.6
1 1/2"	38.1	1.65	50.5	12.7	21.5	28.6
2"	50.8	1.65	64.0	12.7	21.5	28.6
2 1/2"	63.5	1.65	77.5	12.7	21.5	28.6
3"	76.2	1.65	91.0	12.7	21.5	28.6
4"	101.6	2.11	119.0	15.8	21.5	28.6
6"	152.4	2.77	166.8		21.5	38.1
8"	203.2	2.77	217.7		21.5	38.1
10"	254.0	3.40	268.5		21.5	38.1
12"	304.8	3.40	319.3		21.5	38.1





Long Clamp Ferrule-INCH

3A-14MMPW

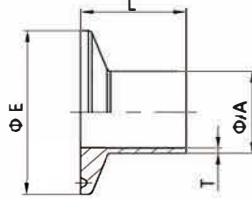

Size	A	T	E	L
1/2"	12.7	1.65	25.2	28.6
3/4"	19.05	1.65	25.2	28.6
1"	25.4	1.65	50.5	36.0
1 1/2"	38.1	1.65	50.5	36.0
2"	50.8	1.65	64.0	36.0
2 1/2"	63.5	1.65	77.5	36.0
3"	76.2	1.65	91.0	48.0
4"	101.6	2.11	119.0	48.0

Clamp Ferrule-INCH

3A-14MPW

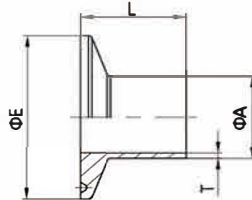

Size	A	T	E	L
1/2"	12.7	1.65	25.2	44.5
3/4"	19.05	1.65	25.2	44.5
1"	25.4	1.65	50.5	44.5
1 1/2"	38.1	1.65	50.5	44.5
2"	50.8	1.65	64.0	57.2
2 1/2"	63.5	1.65	77.5	57.2
3"	76.2	1.65	91.0	57.2
4"	101.6	2.11	119.0	57.2

Clamp Ferrule-SMS

SMS-14MP

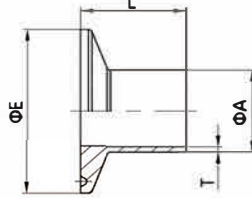

Size	A	T	E	L
1"	25.4	1.50	50.5	21.5
1 1/2"	38.1	1.50	50.5	21.5
2"	63.5	1.50	64.0	21.5
2 1/2"	50.8	1.50	77.5	28.0
3"	76.2	1.50	91.0	28.0
4"	101.6	2.00	119.0	28.0
12"	304.8	2.00	319.0	28.0

Expanding Clamp Ferrule-INCH

3A-14RMP

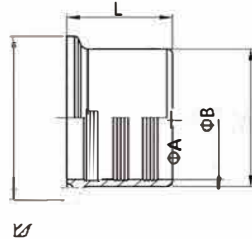

Size	A	B	E	L
1"	29.5	25.5	50.5	19.1
1 1/2"	42.6	38.2	50.5	28.6
2"	55.7	50.9	64.0	33.3
2 1/2"	68.8	63.6	77.5	34.9
3"	81.9	76.3	91.0	36.5
4"	108.1	101.7	119.0	38.1





Clamp Ferrule-ISO

ISO-14MP

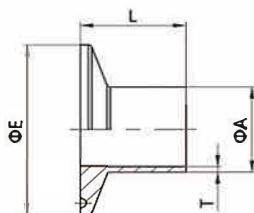

Size	A	T	E	L
10.2	10.2	1.6	34/25	18.0
13.5	13.5	1.6	34/25	18.0
17.2	17.2	1.6	34/25	18.0
21.3	21.3	1.6	34/25	18.0
26.9	26.9	1.6	50.5	21.5
33.7	33.7	2.0	50.5	21.5
42.4	42.4	2.0	50.5	21.5
48.3	48.3	2.0	64.0	21.5
60.3	60.3	2.0	77.5	28.0
76.1	76.1	2.0	91.0	28.0
88.9	88.9	2.0	106.0	28.0
114.3	114.3	2.0	130.0	28.0

Long Clamp Ferrule-ISO

ISO-14MPW

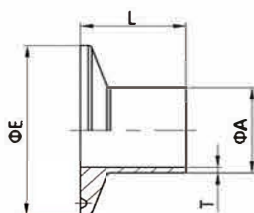

Size	A	T	E	L
10.2	10.2	1.6	34/25	28.6
13.5	13.5	1.6	34/25	28.6
17.2	17.2	1.6	34/25	28.6
21.3	21.3	1.6	34/25	36.0
26.9	26.9	1.6	50.5	36.0
33.7	33.7	2.0	50.5	36.0
42.4	42.4	2.0	50.5	36.0
48.3	48.3	2.0	64.0	36.0
60.3	60.3	2.0	77.5	36.0
76.1	76.1	2.0	91.0	48.0
88.9	88.9	2.0	106.0	48.0
114.3	114.3	2.0	130.0	48.0

Clamp Ferrule-ISO

ISO-14WMP/14MMP/14AMP

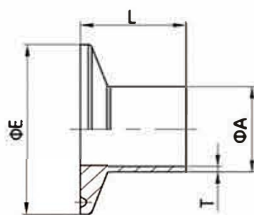

Size	A	T	E	L ¹	L ²	L ³
10.2	10.2	1.6	34/25	12.7	21.5	28.6
13.5	13.5	1.6	34/25	12.7	21.5	28.6
17.2	17.2	1.6	34/25	12.7	21.5	28.6
21.3	21.3	1.6	34/25	12.7	21.5	28.6
26.9	26.9	1.6	50.5	12.7	21.5	28.6
33.7	33.7	2.0	50.5	12.7	21.5	28.6
42.4	42.4	2.0	50.5	12.7	21.5	28.6
48.3	48.3	2.0	64.0	12.7	21.5	28.6
60.3	60.3	2.0	77.5	12.7	21.5	28.6
76.1	76.1	2.0	91.0	12.7	21.5	28.6
88.9	88.9	2.0	106.0	12.7	21.5	28.6
114.3	114.3	2.0	130.0	15.8	21.5	28.6

Clamp Ferrule-ISO

ISO-14WMP/14MMP/14AMP

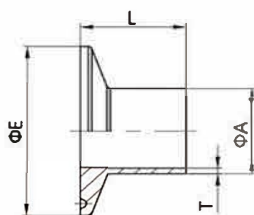

Size	A	T	E	L ¹	L ²	L ³
139.7	139.7	2.0	155.0	15.8	21.5	28.6
168.3	168.3	3.6	183.0		21.5	28.6
219.1	219.1	3.6	233.5		21.5	28.6





Clamp Ferrule-SMS

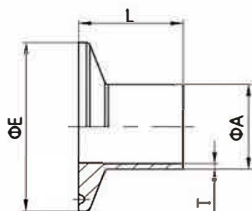

SMS-14WMP/14MMP/14AMP

Size	A	T	E	L ¹	L ²	L ³
25	25	1.25	50.5	12.7	21.5	28.6
32	32	1.25	50.5	12.7	21.5	28.6
38	38	1.25	50.5	12.7	21.5	28.6
51	51	1.25	64.0	12.7	21.5	28.6
63	63.5	1.50	77.5	12.7	21.5	28.6
76	76.1	1.60	91.0	12.7	21.5	28.6
89	89.0	2.00	106.0	12.7	21.5	28.6
101	101.6	2.00	119.0	15.8	21.5	28.6

Clamp Ferrule-ISO/IDF

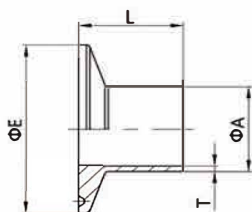

ISO/IDF-14WMP/14MMP/14AMP

Size	A	T	E	L ¹	L ²	L ³
25	25	1.5	50.5	12.7	21.5	28.6
32	32	1.5	50.5	12.7	21.5	28.6
38	38	1.5	50.5	12.7	21.5	28.6
45	45	2.0	64.0	12.7	21.5	28.6
57	57	2.0	77.5	12.7	21.5	28.6
76	76	2.0	91.0	12.7	21.5	28.6
89	89	2.0	106.0	12.7	21.5	28.6
108	108	2.0	119.0	15.8	21.5	28.6

Clamp Ferrule-ISO2852

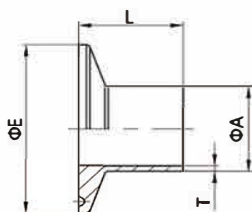

ISO2852-14WMP/14MMP/14AMP

Size	A	T	E	L ¹	L ²	L ³
25	25.6	1.5	50.5	12.7	21.5	28.6
33.7	33.7	1.5	50.5	12.7	21.5	28.6
38	38.6	1.5	50.5	12.7	21.5	28.6
40	40.6	1.5	64.0	12.7	21.5	28.6
51	51.6	1.5	64.0	12.7	21.5	28.6
63.5	63.5	1.6	77.5	12.7	21.5	28.6
70	70.6	1.9	91.0	12.7	21.5	28.6
76.1	76.7	1.9	91.0	12.7	21.5	28.6
88.9	89.8	2.45	106.0	12.7	21.5	28.6

Clamp Ferrule-BS

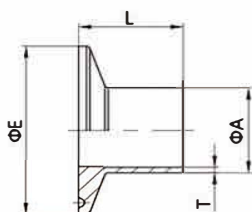

BS-14WMP/14MMP/14AMP

Size	A	T	E	L ¹	L ²	L ³
1"	25.4	1.6	50.5	12.7	21.5	28.6
1 1/2"	38.1	1.6	50.5	12.7	21.5	28.6
2"	50.8	1.6	64.0	12.7	21.5	28.6
2 1/2"	63.5	1.6	77.5	12.7	21.5	28.6
3"	76.2	1.6	91.0	12.7	21.5	28.6
4"	101.6	2.0	106.0	15.8	21.5	28.6





Seal-SMS

SMS-1 3PG/1 3FG

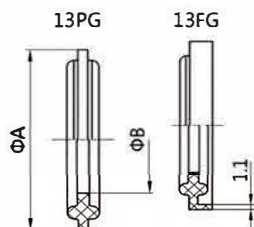

Size	A	B
25	50.5	22.7
32	50.5	29.7
38	50.5	35.7
51	64.0	48.7
63.5	77.5	60.7
76	91.0	72.3
101.6	119.0	97.8

Seal-INCH

3A-1 3PG/1 3FG

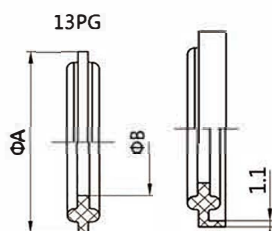

Size	A	B
1.0"	50.5	22.3
1.5"	50.5	35.0
2.0"	64.0	47.7
2.5"	77.5	60.4
3.0"	91.0	73.1
4.0"	119.0	97.6
6.0"	166.8	147.0
8.0"	217.7	197.8
10.0"	268.5	247.5
12.0"	319.3	298.2

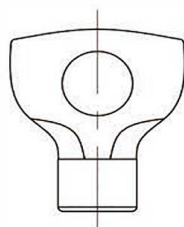

13MHH-14

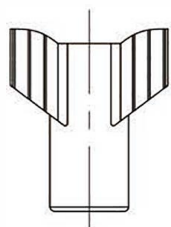

13MHH-11

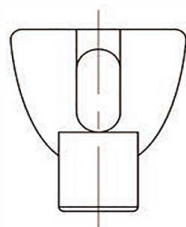

13SP-2

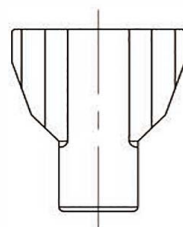

13MHH-12

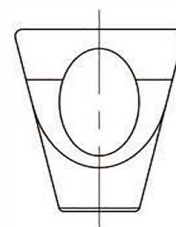

G1-M10

Clamp-INCH

3A-13MHH

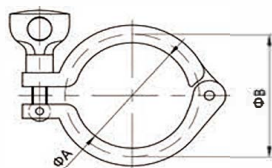

Size	A	B
1/2"-3/4"	20.0	28.0
1.0"-1.5"	44.4	53.6
2.0"	57.8	67.0
2.5"	71.4	80.6
3.0"	84.0	94.2
3.5"	99.0	109.2
4.0"	110.0	122.2
4.5"	123.0	133.2
5.0"	129.0	147.8
6.0"	155.4	170.4
8.0"	205.0	220.0
10.0"	257.0	272.0





Clamp-DIN

DIN-13MHH

Size	A	B
10-20	27.8	37.0
25-40	44.4	53.6
50	57.8	67.0
65	84.0	94.2
80	99.0	109.2
100	110.0	122.2
125	144.0	159.0
150	172.0	187.0
200	222.5	237.5
250	257.0	272.0
300	308.0	323.0

Clamp-ISO

ISO-13MHH

Size	A	B
10.2-21.3	27.8	37.0
26.9-42.4	44.4	53.6
48.3	57.8	67.0
60.3	71.4	80.6
76.1	84.0	94.2
88.9	99.0	109.2
114.3	123.0	133.2
139.7	144.0	159.0
168.3	172.0	187.0
219.1	222.5	237.5

Double-Pin Clamp-INCH

3A-13MHHM

Size	A	B
1/2"-3/4"	20.0	28.0
1.0"-1.5"	44.4	53.6
2.0"	57.8	67.0
2.5"	71.4	80.6
3.0"	84.0	94.2
3.5"	99.0	109.2
4.0"	110.0	122.2
4.5"	123.0	133.2
5.0"	129.0	147.8
6.0"	155.4	170.4
8.0"	205.0	220.0
10.0"	257.0	272.0

Double-Pin Clamp-DIN

DIN-13MHHM

Size	A	B
10-20	27.8	37.0
25-40	44.4	53.6
50	57.8	67.0
65	84.0	94.2
80	99.0	109.2
100	110.0	122.2
125	144.0	159.0
150	172.0	187.0
200	222.5	237.5
250	257.0	272.0
300	308.0	323.0





Double-Pin Clamp-ISO

ISO-13MHHM

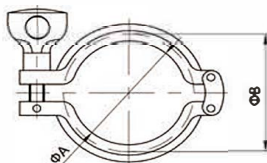

Size	A	B
10.2-21.3	27.8	37.0
26.9-42.4	44.4	53.6
48.3	57.8	67.0
60.3	71.4	80.6
76.1	84.0	94.2
88.9	99.0	109.2
114.3	123.0	133.2
139.7	144.0	159.0
168.3	172.0	187.0
219.1	222.5	237.5

Three-Piece Clamp-INCH

3A-13TP

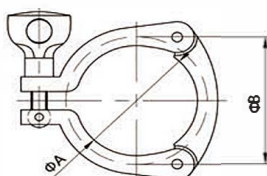

Size	A	B
1/2"-3/4"	20.0	28.0
1.0"-1.5"	44.4	53.6
" 2.0"	57.8	67.0
2.5" 3.0"	71.4	80.6
3.5" 4.0"	84.0	94.2
4.5" 5.0"	99.0	109.2
6.0"	110.0	122.2
8.0"	123.0	133.2
10.0"	155.4	170.4
12.0"	205.0	220.0
15.0"	257.0	272.0

Three-Piece Clamp-DIN

DIN-13TP

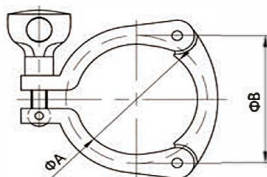

Size	A	B
10-20	27.8	37.0
25-40	44.4	53.6
50 65	57.8	67.0
80	84.0	94.2
100	99.0	109.2
125	110.0	122.2
150	144.0	159.0
175	172.0	187.0
200	222.5	237.5
250	257.0	272.0
300	308.0	323.0

Three-Piece Clamp-ISO

ISO-13TP

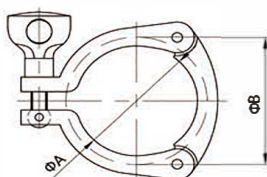

Size	A	B
10.2-21.3	27.8	37.0
26.9-42.4	44.4	53.6
48.3	57.8	67.0
60.3	71.4	80.6
76.1	84.0	94.2
88.9	99.0	109.2
114.3	123.0	133.2
139.7	144.0	159.0
168.3	172.0	187.0
219.1	222.5	237.5





High Pressure Clamp-INCH

3A-13MHP

Size	A	B
1/2"-3/4"	20.0	28.0
1.0"-1.5"	44.4	53.6
2.0"	57.8	67.0
2.5"	71.4	80.6
3.0"	84.0	94.2
3.5"	99.0	109.2
4.0"	110.0	122.2
4.5"	123.0	133.2
5.0"	129.0	147.8
6.0"	155.4	170.4
8.0"	205.0	220.0
10.0"	257.0	272.0

High Pressure Clamp-DIN

DIN-13MHP

Size	A	B
10-20	27.8	37.0
25-40	44.4	53.6
50	57.8	67.0
65	84.0	94.2
80	99.0	109.2
100	110.0	122.2
125	144.0	159.0
150	172.0	187.0
200	222.5	237.5
250	257.0	272.0
300	308.0	323.0

High Pressure Clamp-ISO

ISO-13MHP

Size	A	B
10.2-21.3	27.8	37.0
26.9-42.4	44.4	53.6
48.3	57.8	67.0
60.3	71.4	80.6
76.1	84.0	94.2
88.9	99.0	109.2
114.3	123.0	133.2
139.7	144.0	159.0
168.3	172.0	187.0
219.1	222.5	237.5

Pressed Clamp-DIN

13CS

Size	A
25-40	58.5
50	72.0
65	84.0
80	99.0
100	127.0

